

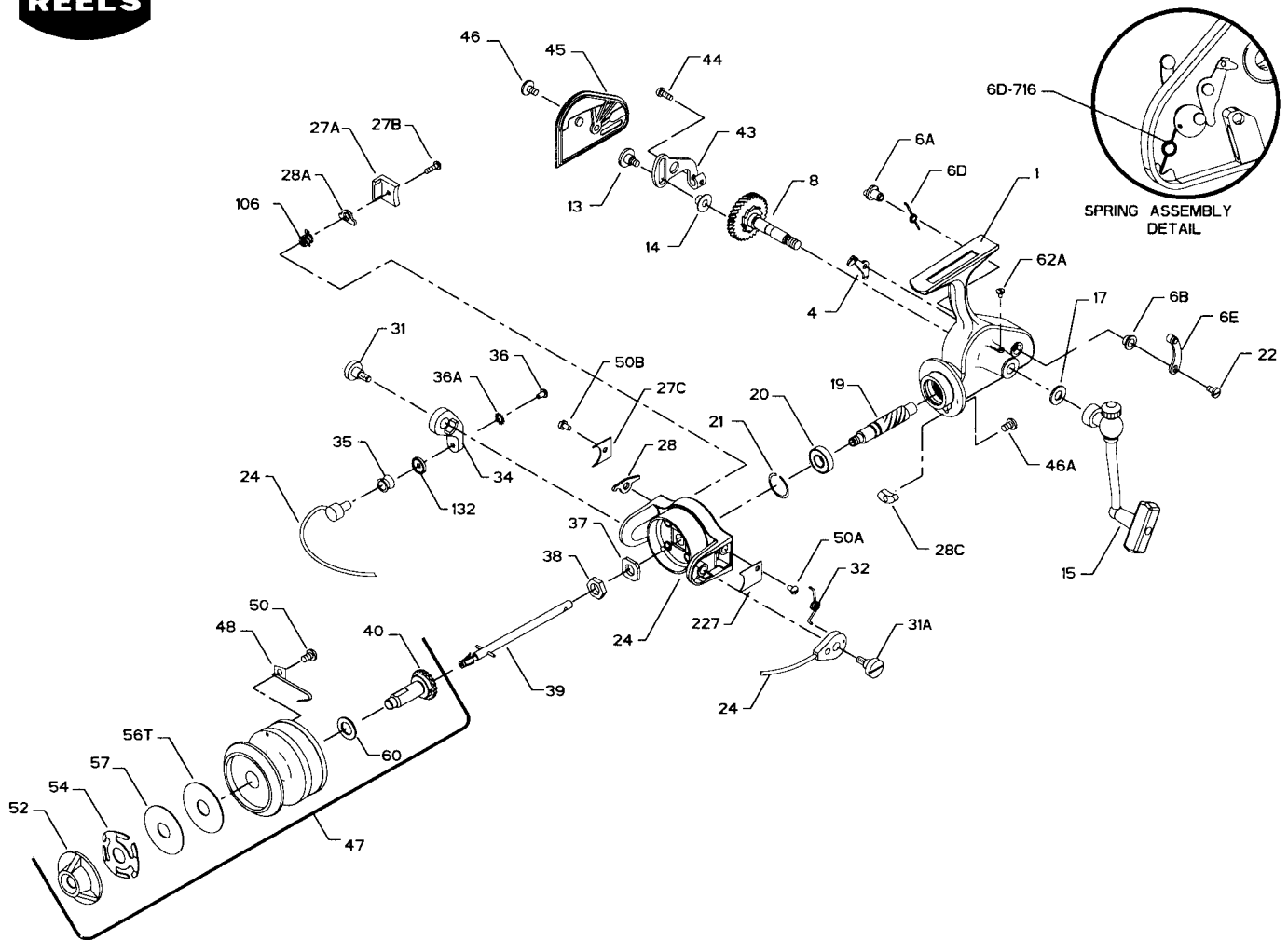

PARTS AND PRICE LIST FOR MODEL 420SS AND 430SS



Key No.	Part No.	Description	Price	Key No.	Part No.	Description	Price
1	1-420	Housing w/Bushing	\$13.05	36	36-420	Bail Stud Screw	.45
	1-430	Housing w/Bushing	13.05	36A	36A-750	Lock Washer	.45
4	4-420	Dog	1.10	37	37-420	Rotor Cup Washer	.45
6A	6A-716	Eccentric	1.10	38	38-720	Rotor Cup Nut	.50
6B	6B-700Z	Eccentric Liner	.40	39	39-420	Spool Shaft (Complete)	3.40
6D	6D-716	Eccentric Spring	.40	40	40-716	Spool Sleeve (Complete)	2.70
6E	6E-716	Eccentric Lever	.90	43	43-716	Crosswind Arm	1.50
7	7-716	Pinion Bushing	.50	44	44-716	Crosswind Shaft Screw	.40
8	8-420	Main Gear Ratchet & Shaft	8.80	45	45-420	Housing Cover	2.25
13	13-716	Crosswind Screw	.50	45	45-430	Housing Cover	2.25
14	14-716	Crosswind Roller	.45	46	46-716	Housing Cover Screw	.50
15	15-716Z	Handle Complete (420)	6.60	46A	46A-704	Housing Plate Screw	.45
	15-714Z	Handle Complete (430)	6.60	47	47-420	Spool (Complete)	15.50
17	17-716	Handle Washer	.50	47	47-430	Spool (Complete)	16.25
19	19-420	Pinion Gear	8.80	48	48-420	Click Spring	.45
20	20-722	Bail Bearing	12.95	48	48-430	Click Spring	.45
21	21-722	Bearing Retainer	.50	50	50-420	Click Spring Screw	.45
22	22-109	Eccentric Screw	.50	50A	50-712	Bail Spring Cover Screw	.50
24	24-420	Bail Wire	6.60	50B	50-716	Trip Lever Cover Screw	.45
	24-430	Bail Wire	7.15	52	52-716Z	Drag Knob (420)	1.90
27	27-420	Rotor Cup	10.80		52-714Z	Drag Knob (430)	1.90
	27-430	Rotor Cup	12.15	54	54-716	Drag Spring (420)	1.95
27A	27A-420	Bail Trip Cover	1.10		54-714	Drag Spring (430)	2.05
27B	27B-420	Bail Trip Cover Screw	.50	56T	56T-716	Drag Washer (Teflon®) (420)	.80
27C	27C-420	Trip Lever Cover	.50		56T-714	Drag Washer (Teflon®) (430)	.80
28	28-420	Trip Lever	1.70	57	57-716	Metal Keyed Washer (420)	.60
28A	28A-450	Cam Lever	1.60		57-430	Metal Keyed Washer (430)	.60
28C	28C-420	Trip Cam	1.10	60	60-716	Rear Drag Washer	.45
31	31-420	Bail Arm Screw	1.00	62A	62A-716	Oiler Screw	.40
31A	31A-420	Bail Cam Screw	1.00	106	106-450	Lever Spring	.50
32	32-420	Bail Spring	.90	132	132-420	Roller Washer	.80
34	34-420	Bail Arm	2.25	227	227-420	Bail Spring Cover	.50
35	35-420	Line Roller	3.10				